

# SIGNUM

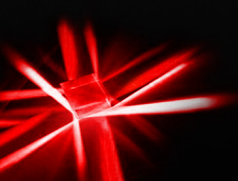

Signum is a super-powerful compact LED projector designed specifically for projections in the most demanding conditions (for instance, permanent outdoor installations or harsh industrial environments) due to the absence of fans, the degree of protection of IP65 and LED life of 50.000 hours. Its functional and innovative design, makes it possible to project high quality images, logos, signs and photos. The real surprise of this small 50W LED projector is its brightness: 2.163 lux at a distance of 5 meters (with 18° lens), making it the best energy efficiency projector on the market today.



# SIGNUM

## BODY

Material	Aluminium
Protection Rating	IP65
IK Rating	IK09
Surface Finishing	Black Painting RAL 9005

## POWER SUPPLY

Power Mode	110-240V 50/60Hz
------------	------------------

## MAIN FEATURES

Light Source	CITILED COB
Colour Temperature	6.000 °K
Gobo Size	O.D. ø37,5mm - I.D. ø30mm

Power Mode	50W			75W			Line
Luminous Flux Source	7.100 lm			9.600 lm			9.610 lm
Optical System	56 mm	90 mm	140 mm	56 mm	90 mm	140 mm	Line Lens
Angular Aperture	32°	18°	12°	32°	18°	12°	65°
Illuminance max at 5m	700	1825	4700	900	2325	6100	1520
Optical Efficiency	56%	51%	49%	56%	51%	48%	36%
Total Lumen Output	<b>4.000 lm</b>	<b>3.600 lm</b>	<b>3.460 lm</b>	<b>5.400 lm</b>	<b>4.900 lm</b>	<b>4.650 lm</b>	<b>3.400 lm</b>
Luminous Efficacy	80 lm/W	72 lm/W	69 lm/W	72 lm/W	66 lm/W	62 lm/W	45 lm/W

## OPTIONAL \*

Controllable with Casambi via Android and IOS app. (on / off - network creation - batch or single control  
WIRELESS proximity sensor activation (creation of networks up to 32 units - operation under WIFI network  
or in Cloud)

Compatible with DALI and DMX networks

## WEIGHT

6 kg

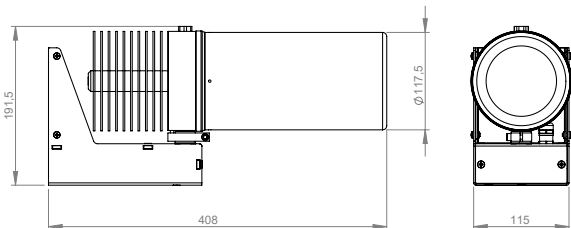

\*extra cost to be calculated

# SIGNUM

## MODEL

## CODE

<b>Signum 50W-W</b>	<b>111B200</b>
---------------------	----------------

Lens 56 mm	1119200
------------	---------

<b>Signum 50W-N</b>	<b>111B100</b>
---------------------	----------------

Lens 90 mm	1119100
------------	---------

<b>Signum 50W-EN</b>	<b>111B140</b>
----------------------	----------------

Lens 140 mm	1119500
-------------	---------

<b>Signum 75W-W</b>	<b>111C200</b>
---------------------	----------------

Lens 56 mm	1119200
------------	---------

<b>Signum 75W-N</b>	<b>111C100</b>
---------------------	----------------

Lens 90 mm	1119100
------------	---------

<b>Signum 75W-EN</b>	<b>111C140</b>
----------------------	----------------

Lens 140 mm	1119500
-------------	---------

<b>Signum 75W-N</b>	<b>111CL00</b>
---------------------	----------------

Lens Line f100	1119445
----------------	---------

## ACCESSORIES

Lens 56 mm	1119200
------------	---------

Lens 90 mm	1119100
------------	---------

Lens 140 mm	1119500
-------------	---------

Beam Shaper	1118000
-------------	---------

Motion sensor	RIL0001
---------------	---------

Pole mounting bracket	1115000
-----------------------	---------

Extension cable L 1.5m	CAB0019
------------------------	---------

Electric plug Schuko IP54	SPN0001
---------------------------	---------

# CASE STUDIES

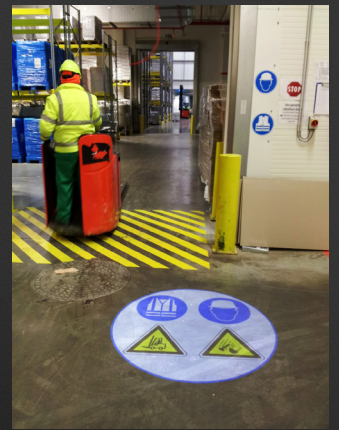

# PHOTOMETRIC DIAGRAMS

## SIGNUM 50W

Projection Lens Focal 90 mm - Angle aperture 18° (I.D. ø30mm)  
 Total lumen output: 3.600 lm - Luminous efficacy: 72 lm/W - Optical Efficiency: 51%

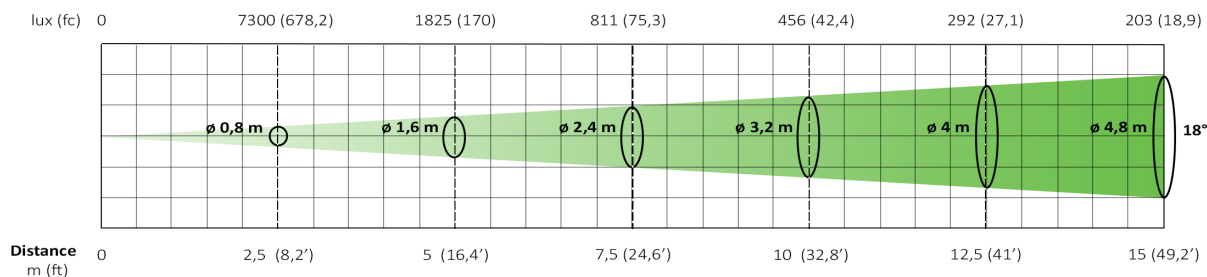

Projection Lens Focal 56 mm - Angle aperture 32° (I.D. ø30mm)  
 Total lumen output: 4.000 lm - Luminous efficacy: 80 lm/W - Optical Efficiency: 56%

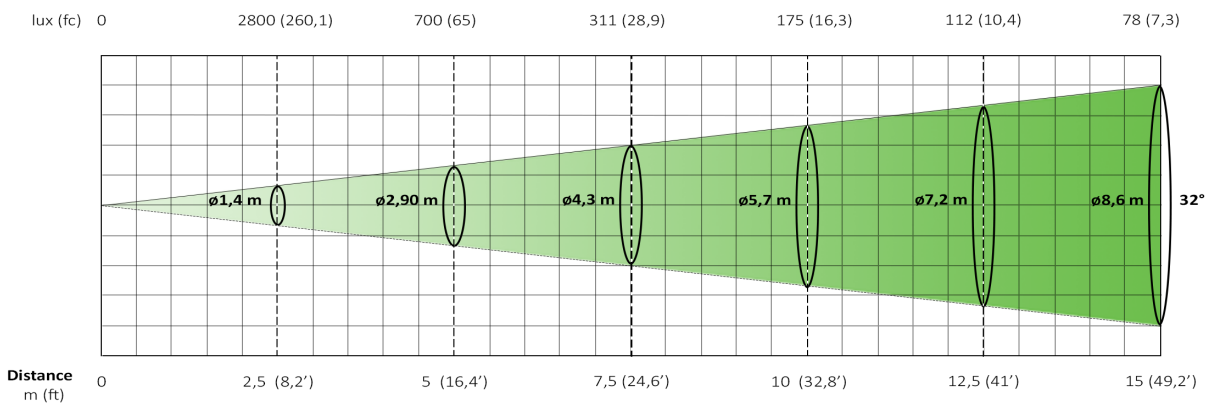

Projection Lens Focal 140 mm - Angle aperture 12° (I.D. ø30mm)  
 Total lumen output: 3.460 lm - Luminous efficacy: 69 lm/W - Optical Efficiency: 49%

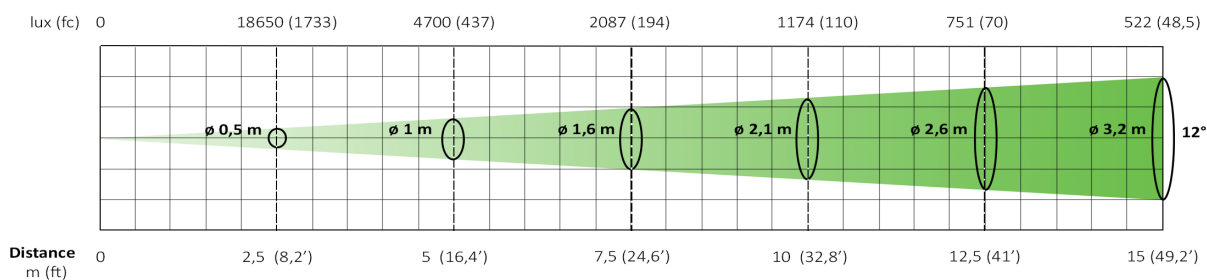

# PHOTOMETRIC DIAGRAMS

## SIGNUM 75W

Projection Lens Focal 90 mm - Angle aperture 18° (I.D. ø30mm)  
 Total lumen output: 4.900 lm - Luminous efficacy: 66 lm/W - Optical Efficiency: 51%

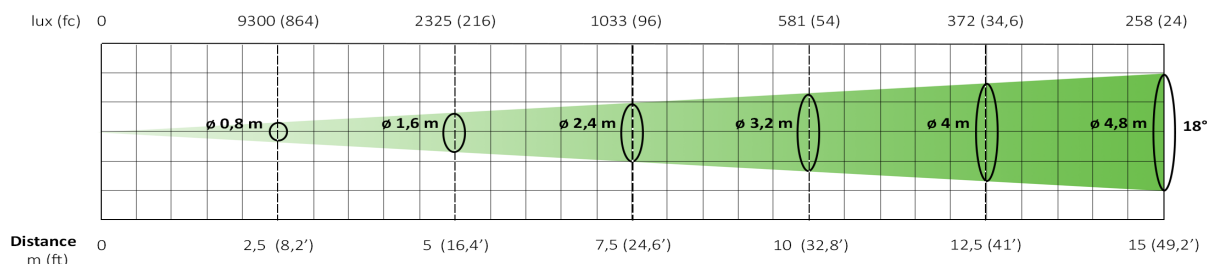

Projection Lens Focal 56 mm - Angle aperture 32° (I.D. ø30mm)  
 Total lumen output: 5.400 lm - Luminous efficacy: 72 lm/W - Optical Efficiency: 56%

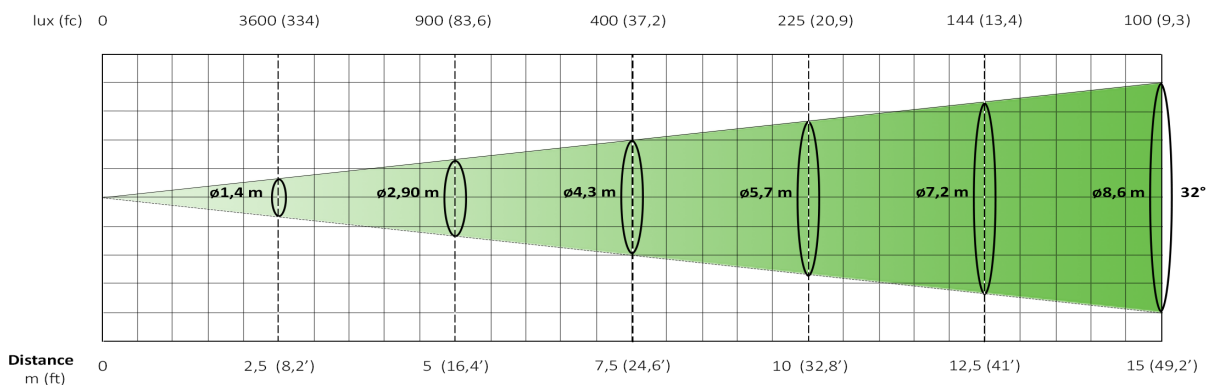

Projection Lens Focal 140 mm - Angle aperture 12° (I.D. ø30mm)  
 Total lumen output: 4650 lm - Luminous efficacy: 62 lm/W - Optical Efficiency: 48%

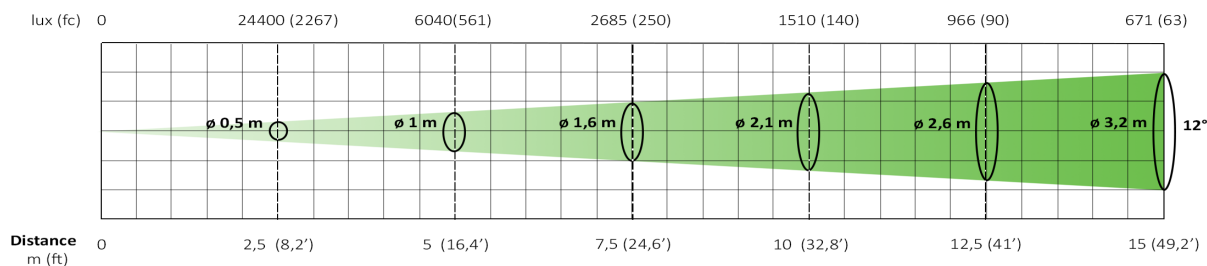

Discover all **OPTIONAL ACCESSORIES** on <https://store.goboservice.com/en/projectors-accessories.html>

